

# BrakeRack

By Safety Hoist Company

## Installation Manual

### BR-22000 Model



## IMPORTANT: Please Read Before Setup:

*The Brake Rack is designed for, and compatible with, major brands' contractor and residential brake models with a maximum throat depth of 14", and a maximum length of 10'6".*

*Compatibility with truck models/ladder rack models may vary. Please watch our installation video to assess whether this product will work for your vehicle.*



Scan to Watch

## BR-22000 Model for Installation Instructions

- 1 Brake Rack **BR-22000** is to be installed in accordance with mounting template closed, taking note that there is a top and bottom to the mounting template.
- 2 The **BR-22000** is **ONLY** to be mounted to **permanently** installed steel or aluminum ladder racks that can **SAFELY** take the weight of the break **when installed.**
- 3 The **BR-22000** is provided with a  $\frac{1}{2} \times 2 \frac{3}{4}$  **STOP BOLT** mounted for "vertical" post ladder racks to position the brake **horizontally** in the lowered position.
- 4 IF your ladder rack is **angled** off the vertical, reposition the **STOP BOLT** into one of the 10-degree holes that is most appropriate to adjust the arm to horizontal with brake rack in lowered position. Use the  $\frac{3}{4}$  Outside Diameter by  $1 \frac{1}{2}$  long **spacer** to make fine tune adjustments in addition to the 10-degree holes supplied on the **BR-22000** body.

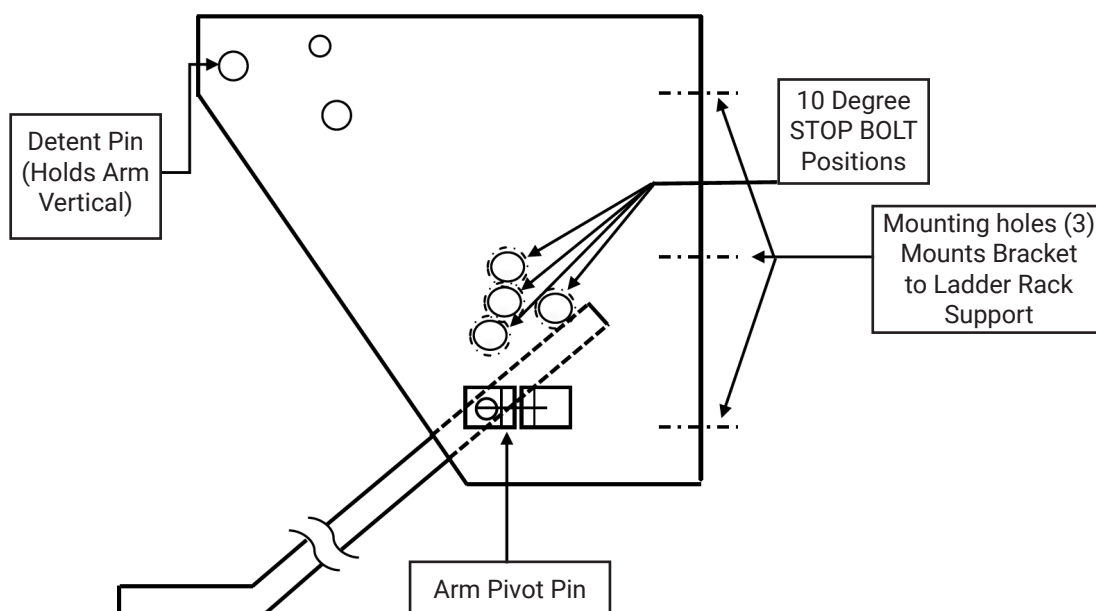

## Mounting of Brake to Brake-Rack Swing Arm

**Method I** – If you have access to support rail of brake, drill hole directly through rail as shown in figure. Method I Mounting. Use the Brake Rack swing arm hole pattern as a guide in drilling holes in the rails. Drill 4 holes in brake to mount it securely to Brake Rack swing arm.

**Method II** – If you don't have direct access to the Brake rails or chose not to drill through them, Method II allows mounting using a clamp plate. 4 clamp plates are supplied. Use 1 clamp plate and 2 bolts in 4 locations to mount the Brake securely to the Brake Rack Swing Arm. See figure Method II Mounting No drilling is required. Use 2 holes in Brake Rack Swing Arm.

**Note:** If Brake is too deep for Brake Rack Swing Arm mounting hole pattern, or you want to mount the Brake further out from side of the truck, we have provided 2 steel angles pre-drilled. Use these angles to extend the swing arm mounting area. See Figure Below.

### **Method I**

DRILL 13/32 HOLE  
THROUGH RAILS OR  
BRAKE BASE.

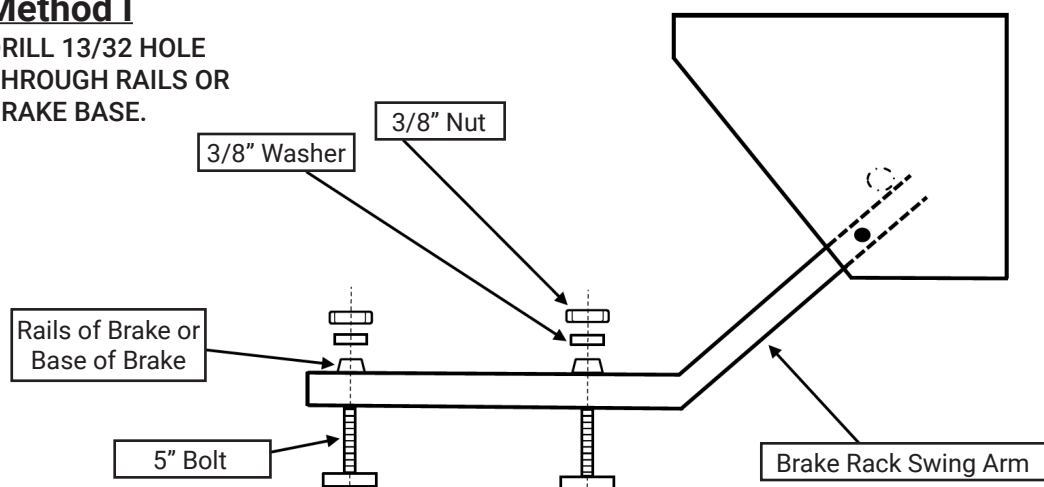

### **Method II**

CLAMP RAILS USING  
CLAMP PLATES IN 4  
PLACES.

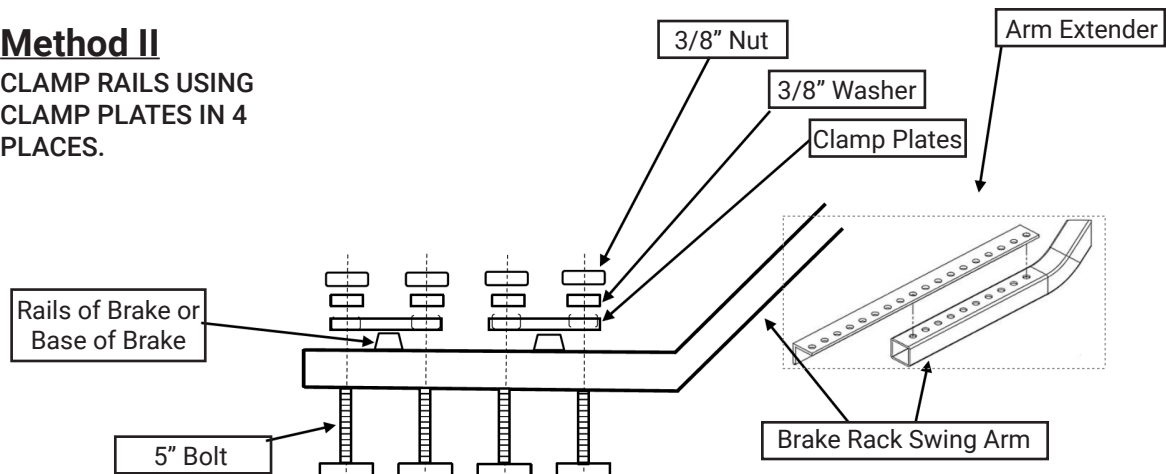

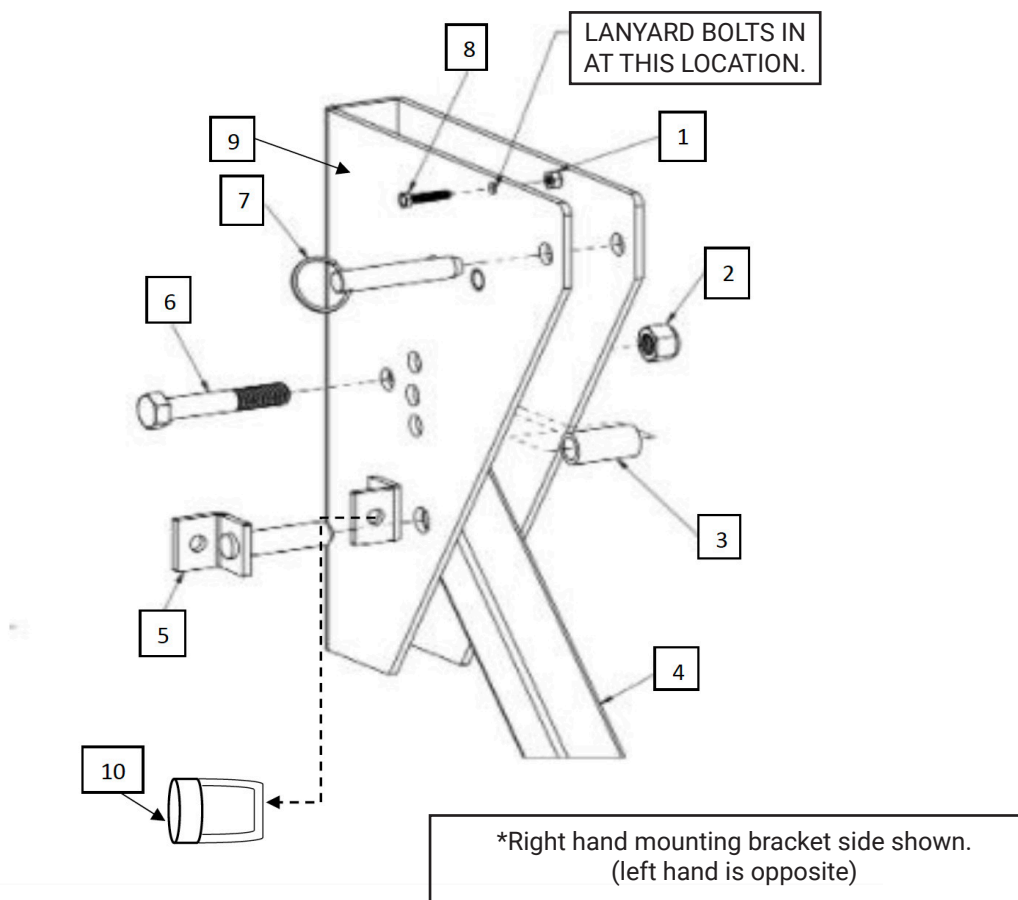

| Item | Description              |
|------|--------------------------|
| 1    | NUT & LOCK               |
| 2    | ½ -13 NYLON LN           |
| 3    | SLEEVE                   |
| 4    | MOUNTING ARM             |
| 5    | ARM PIVOT PIN            |
| 6    | HEX HD. BOLT ½ - 13X 2 ¼ |
| 7    | DETENT PIN               |
| 8    | HEX HD. BOLT             |
| *9   | MOUNTING BRACKET         |
| 10   | PADLOCK                  |

## Overview – Mounting Bracket to Ladder Racks

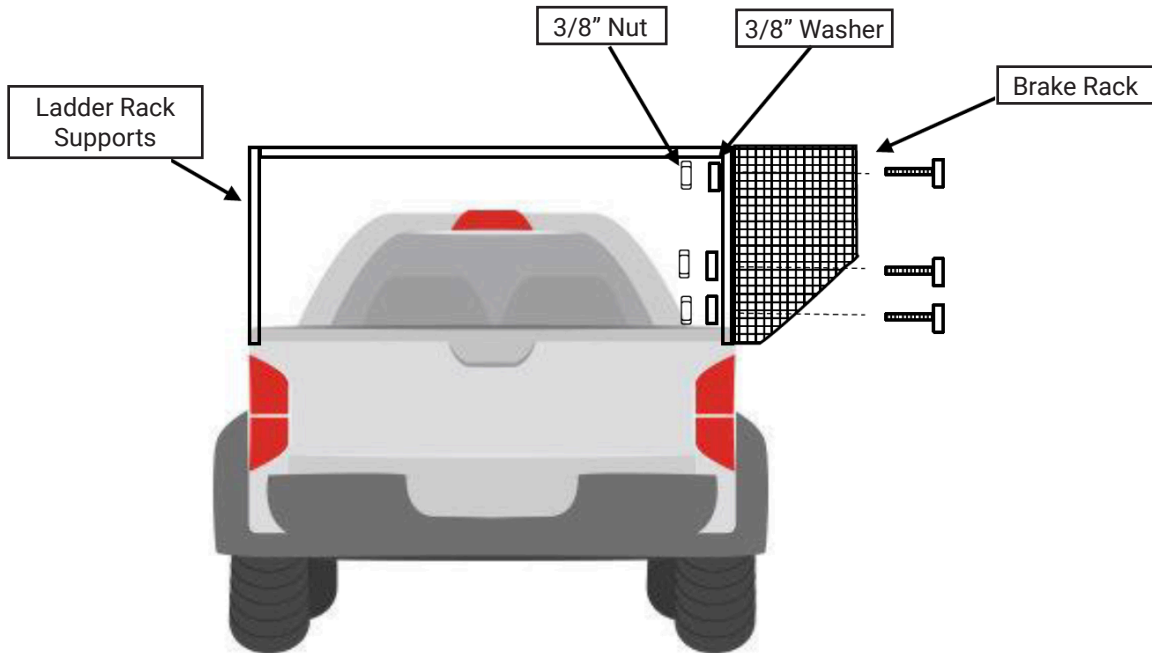

### Swung Down for Work Position

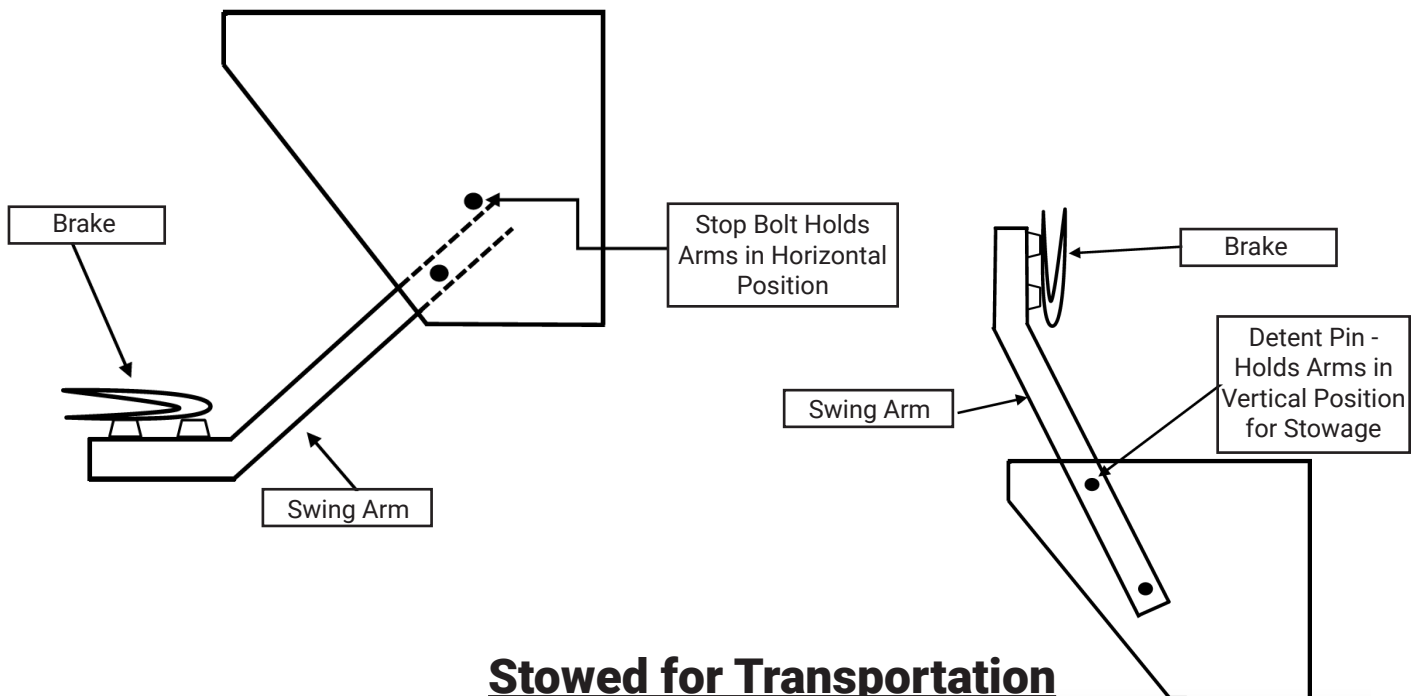

### Stowed for Transportation

# More From SAFETY HOIST<sup>CO.</sup>



Gas Material Hoists



Electric Material Hoists

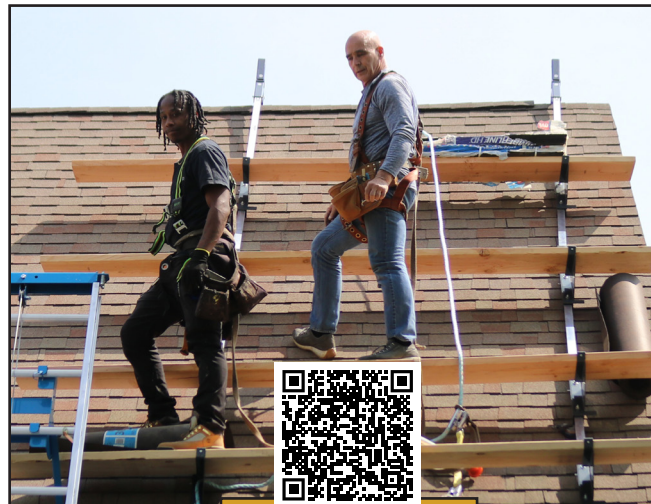

SteepSlope Scaffold

## SAFETY HOIST<sup>CO.</sup>

Safety Hoist Company • 604 Jeffers Circle • Exton, Pennsylvania 19331  
[www.safetyhoistcompany.com](http://www.safetyhoistcompany.com) • [info@safetyhoistcompany.com](mailto:info@safetyhoistcompany.com)