

1 HP Dust Collector



Operator's Manual

Record the serial number and date of purchase in your manual for future reference.

Serial Number: _____ Date of purchase: _____

For technical support or parts questions, email techsupport@rikontools.com or call toll free at (877)884-5167









Operator Safety: Required Reading

IMPORTANT! Safety is the single most important consideration in the operation of this equipment. The following instructions must be followed at all times.

There are certain applications for which this tool was designed. We strongly recommend that this tool not be modified and/or used for any other application other than that for which it was designed. If you have any questions about its application, do not use the tool until you have contacted us and we have advised you.

General Safety Warnings

KNOW YOUR POWER TOOL. Read the owner's manual carefully. Learn the tool's applications, work capabilities, and its specific potential hazards.

 ⚠ DANGER	ALWAYS GROUND ALL TOOLS. If your tool is equipped with a three-pronged plug, you must plug it into a three-hole electric receptacle. If you use an adapter to accommodate a two-pronged receptacle, you must attach the adapter plug to a known ground. Never remove the third prong of the plug. ALWAYS AVOID DANGEROUS ENVIRONMENTS. Never use power tools in damp or wet locations. Keep your work area well lighted and clear of clutter.
 ⚠ DANGER	ALWAYS REMOVE THE ADJUSTING KEYS AND WRENCHES FROM TOOLS AFTER USE. Form the habit of checking to see that keys and adjusting wrenches are removed from the tool before turning it on. ALWAYS KEEP YOUR WORK AREA CLEAN. Cluttered areas and benches invite accidents.
 ⚠ DANGER	ALWAYS KEEP VISITORS AWAY FROM RUNNING MACHINES. All visitors should be kept a safe distance from the work area. ALWAYS MAKE THE WORKSHOP CHILDPROOF. Childproof with padlocks, master switches, or by removing starter keys.
 ⚠ DANGER	NEVER OPERATE A TOOL WHILE UNDER THE INFLUENCE OF DRUGS, MEDICATION, OR ALCOHOL.
 ⚠ DANGER	ALWAYS WEAR PROPER APPAREL. Never wear loose clothing or jewelry that might get caught in moving parts. Rubber-soled footwear is recommended for the best footing.
 ⚠ DANGER	ALWAYS USE SAFETY GLASSES AND WEAR HEARING PROTECTION. Also use a face or dust mask if the cutting operation is dusty.
 ⚠ DANGER	NEVER OVERREACH. Keep your proper footing and balance at all times.
 ⚠ DANGER	NEVER STAND ON TOOLS. Serious injury could occur if the tool is tipped or if the cutting tool is accidentally contacted.

⚠ DANGER**ALWAYS DISCONNECT TOOLS.**

Disconnect tools before servicing and when changing accessories such as blades, bits, and cutters.

**ALWAYS AVOID ACCIDENTAL STARTING.**

Make sure switch is in “OFF” position before plugging in cord.

NEVER LEAVE TOOLS RUNNING UNATTENDED.**⚠ DANGER****ALWAYS CHECK FOR DAMAGED PARTS.**

Before initial or continual use of the tool, a guard or other part that is damaged should be checked to assure that it will operate properly and perform its intended function. Check for alignment of moving parts, binding of moving parts, breakage of parts, mounting, and any other conditions that may affect its operation. A guard or other damaged parts should immediately be properly repaired or replaced.



Special Safety Rules For Dust Collectors

1. Do not operate this machine until you have read all of the following instructions.
2. Do not attempt to operate this machine until it is completely assembled.
3. Do not turn ON this machine if any pieces are missing.
4. If you are not familiar with the operation of the machine, obtain assistance from a qualified person.
5. It is highly recommended that this machine be placed on a level surface.
6. Always wear protective eyewear prior to operating this machine.
7. Do not operate this machine if you are under the influence of drugs and/or alcohol.
8. Remove all jewelry prior to operating this machine.
9. Do not wear any gloves while operating this machine.
10. Always make sure the power switch is in the OFF position prior to plugging in the machine.
11. Always make sure the power switch is in the OFF position when doing any assembly or setup operation.
12. Always wear a dust mask when cleaning or working near a dust collector.
13. The use of any accessories or attachments not recommended may cause injury to you and damage your machine.
14. This machine must be properly grounded.
15. Always keep your face and hands clear of moving parts such as impellers and fans.
16. Keep these instructions for future reference.

California Proposition 65 Warning

WARNING: Some dust created by power sanding, sawing, grinding, drilling, and other construction activities contains chemicals known to the State of California to cause cancer and birth defects or other reproductive harm. Your risk from exposure to these chemicals varies, depending on how often you do this type of work. To reduce your exposure, work in a well-ventilated area and with approved safety equipment, such as dust masks that are specially designed to filter out microscopic particles.

For more detailed information about California Proposition 65 visit www.rikontools.com.

SAVE THESE INSTRUCTIONS.

Refer to them often.

Table of Contents

Safety Warnings.....	2-3
Dust Collector Safety Rules	3
Specifications	4
Contents of Package	5
Assembly	6-8
Operation.....	9
Dust Hazards and Safety.....	9
Electrical Requirements	10
Trouble Shooting.....	11
Wiring Diagram.....	11
Parts List	12
Parts Explosion.....	13
Warranty	14
Notes.....	15

Specifications

Model No.	60-100
Specifications	
Cubic Feet Per Minute	640 CFM
Motor	1 HP
Amps	7
Volts	115V, 60 Hz
Motor Speed	3,450
Blower Wheel Diameter	9"
Blower Wheel Material	Steel
Sound Rating @ 3 Feet	<78 dB
Bag Filtration	5 Microns
Bag Diameter	14-3/4"
Bag Capacity	2.1 Cubic Feet
Bag Length	26"
Hose Connection	1 @ 4"
Overall	
Length	32-1/4"
Width	15"
Height	60"
Net Weight	60 lbs.
Shipping Weight	68 lbs.
Shipping Carton	30" x 18" x 18-1/4"
Warranty	5 Years

Contents of Package

When unpacking, check to make sure the following parts are included. If any parts are missing or broken, please call RIKON Power Tools at the number on the cover of this manual as soon as possible.

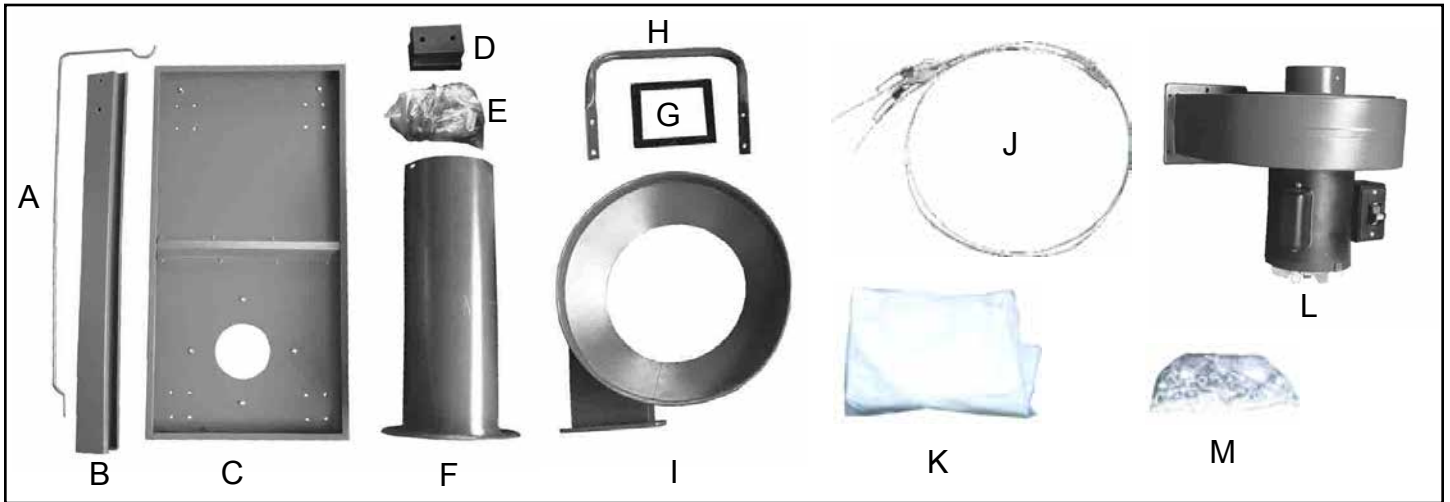

A	Upper bag support	H	Handle
B	Vertical supports	I	Collector housing
C	Base plate	J	Straps
D	Spacer blocks	K	Dust bags
E	Bag of casters	L	Motor & housing
F	Column	M	Bag of loose parts
G	Rubber gasket		

Assembly

Installing Casters to Base

Locate the four swivel casters, four M5 hex nuts, four 5MM flat washers and four M5X8MM hex head screws from the hardware pack.

1. Turn over the base plate and align the holes on base plate with the holes from swivel caster.
2. Place the screws through the holes from the front side of base plate. Install the flat washers and hex nuts onto the screws and tighten (Fig. 01).
3. Repeat steps 1 and 2 for the remaining three swivel caster assemblies.



Fig. 01

Mounting Column to Base

Locate the column, four M8X10MM hex bolts and four 8MM washers.

1. Lay the column onto the base. Align the holes in the column with the holes in the base.
2. Place a washer over a hex bolt and insert through the column into the the threaded hole in the base (A-Fig. 02).
3. Repeat steps 1 and 2 for the remaining three hex bolts and tighten.

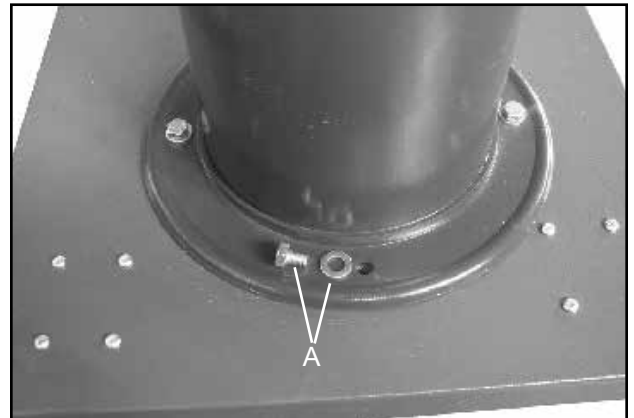

Fig. 02

Mounting Collector Motor to Column

Locate the collector motor, four M6X10MM hex bolt and four 6MM washers.

1. Place the collector motor into the column. Align the holes in the column with the holes in the collector motor.
2. Install a washer over a hex bolt and insert through the column into the the threaded hole in the collector motor (A-Fig. 03).
3. Repeat steps 1 and 2 for the remaining two mounting positions and tighten.



Fig. 03

Installing the Vertical Supports

Locate the two vertical support bars, two M8X10MM hex bolts and two 8MM washers.

1. Hold the vertical support bar upright over the hole located at the corner of the base as shown.
2. Place a washer onto a hex bolt and insert into the bottom hole of the vertical support and into the threaded hole in the base (Fig. 04).

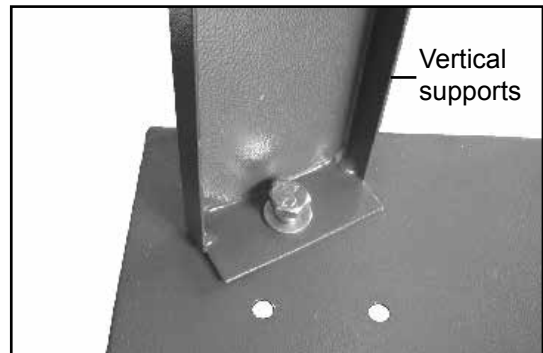

Fig. 04

Mounting the Filtration Housing

Locate the filtration housing, six M6X10MM hex bolts, six 6MM washers and the rubber gasket.

1. Align the holes of the mounting flange for the filtration housing with the holes for the mounting flange of the collector motor.
2. Place the rubber gasket between both mounting flanges (Fig. 05).
3. Secure the assembly with the six M6X10MM hex bolts and six 6MM washers.

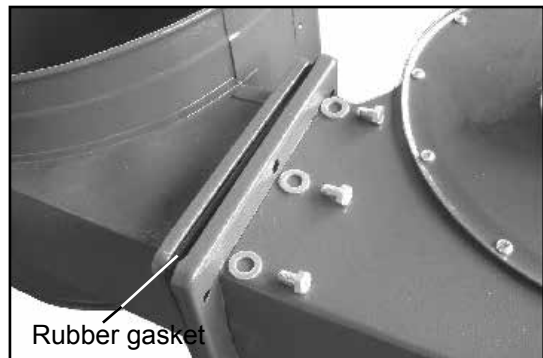

Fig. 05

Installing the Handle and Spacer Blocks

Locate the handle, two spacer blocks, four M8X45MM hex bolts, four 8MM hex nuts and eight 8MM washers.

1. Align the holes of the handle and spacer blocks with mounting holes in the filtration housing.
2. Place the rubber gasket between both mounting flanges (Fig. 06).
3. Secure the assembly with the six M8X45MM hex bolts and six 8MM washers.

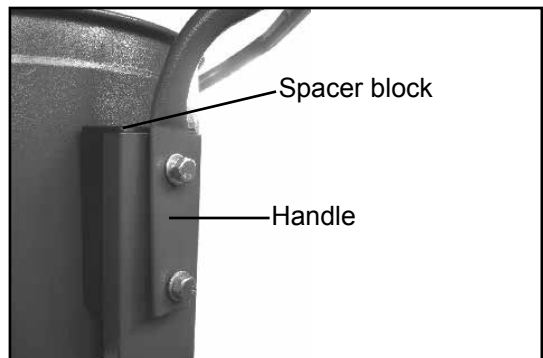

Fig. 06

Installing the Upper Bag Support

Note: If you purchased the optional canister this step can be omitted. Insert washers and screws into the filtration housing to fill unused holes.

Locate the two M4X12MM hex bolts and two 4MM washers.

Install the upper bag support to the side of the filtration housing with hook pointing as shown (A--Fig. 07).



Fig. 07

Assembly Continued

Threading Band Straps in Filter Bags

- 1.) Unfold both bags and lay on a flat surface.
- 2.) Locate the slit on the right side of the top lip of each bag.
- 3.) Start the slotted catch end of the band strap through the right slit (Fig. 08).
- 4.) Work the strap around the inside of the bag until it emerges through the slot on the left side.

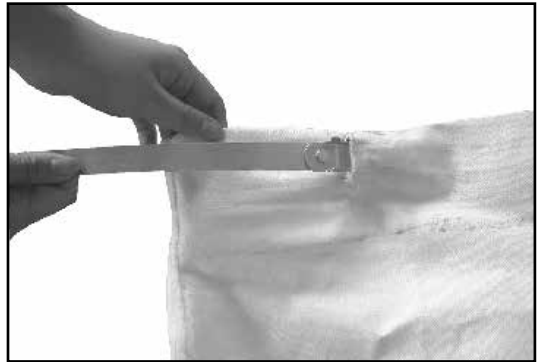

Fig. 08

Installing Filter Bags to the Collector Housing

Note: If you purchased the optional canister this step can be omitted for the top bag only.

- 1.) Slide the filter bag over the collector housing.
- 2.) Engage the catch end of the strap with the clasp in the appropriate slot to ensure a tight fit (Fig. 09).
- 3.) Press the lever with the palm of your hand to lock the clamp.
- 4.) To release the clamp, lift up on the lever. If the lever is hard to disengage simply use a flat head screwdriver to pry the lever upwards.
- 5.) Hang the upper bag from the hook on the upper bag support (Fig. 10).



Fig. 09



Fig. 10

Operation

On/Off Locking Switch

Caution: Make sure that the On/Off locking switch is in the “Off” position before plugging the dust collector into a power source.

The On/Off Locking Switch has a center key that can be used to prevent unauthorized use of the dust collector. The switch needs to have the center key inserted before the machine can be used. (Fig. 11)

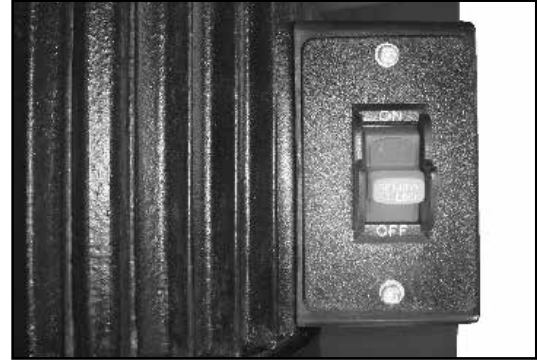

Fig. 11

Dust Hazards and Safety

Grounding the Duct Work

Dust particles moving through flexible or rigid plastic duct work can cause static electricity build-up. The duct work must be properly grounded to ensure that static discharge does not ignite fine dust particles causing an explosion or fire.

To properly ground plastic duct work simply run a small gauge bare copper wire through the ducting and have it emerge from the hose at the dust collector and at each dust producing machine. The bare copper wire should be bonded to the metal shell of each machine by means of a metal screw. The screw must be threaded into the metal shell to ensure a good connection.

The grounding of metal duct work is similar, the only difference is that there is no need to run the bare copper wire inside the ducting. It can be wrapped along the out side of the ducting and should be bonded to each machine as described above.

Emptying and Cleaning the Dust Collector

Caution: Make sure that the dust collector is unplugged before cleaning or servicing.

Always wear a dust mask or respirator while emptying the collector bags or cleaning the dust collector. Please refer to the California Proposition 65 warning on page 3 of this manual regarding hazards from exposure to wood dust. For more detailed information visit www.rikontools.com or www.oehha.ca.gov.

Electrical Requirements

In the event of a malfunction or breakdown, grounding provides a path of least resistance for electric current to reduce the risk of electric shock. This tool is equipped with an electric cord having an equipment-grounding conductor and a grounding plug. The plug must be plugged into a matching outlet that is properly installed and grounded in accordance with all local codes and ordinances.

Do not modify the plug provided. If it will not fit the outlet, have the proper outlet installed by a qualified electrician.

Improper connection of the equipment-grounding conductor can result in a risk of electric shock. The conductor, with insulation having an outer surface that is green with or without yellow stripes, is the equipment-grounding conductor. If repair or replacement of the electric cord or plug is necessary, do not connect the equipment-grounding conductor to a live terminal.

Check with a qualified electrician or service personnel if the grounding instructions are not completely understood, or if in doubt as to whether the tool is properly grounded.

Use only three wire extension cords that have three-prong grounding plugs and three-pole receptacles that accept the tool's plug.*

Repair or replace a damaged or worn cord immediately.

This tool is intended for use on a circuit that has an outlet that looks the one illustrated in Figure A below. The tool has a grounding plug that looks like the grounding plug as illustrated in Figure A below. A temporary adapter, which looks like the adapter as illustrated in Figure B below, may be used to connect this plug to a two-pole receptacle, as shown in Figure B if a properly grounded outlet is not available.** The temporary adapter should only be used until a properly grounded outlet can be installed by a qualified electrician. The green colored rigid ear or tab, extending from the adapter, must be connected to a permanent ground such as a properly grounded outlet box.

* Canadian electrical codes require extension cords to be certified SJT type or better.

** Use of an adapter in Canada is not acceptable.

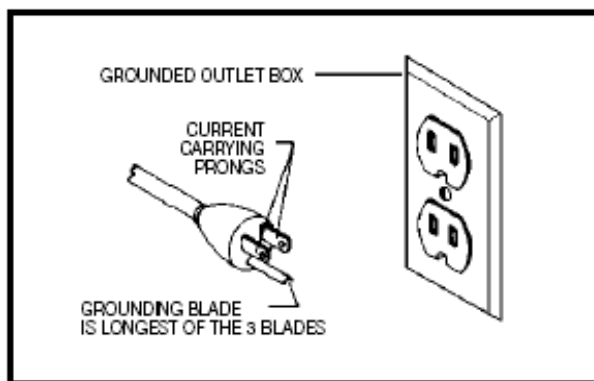

Fig. A

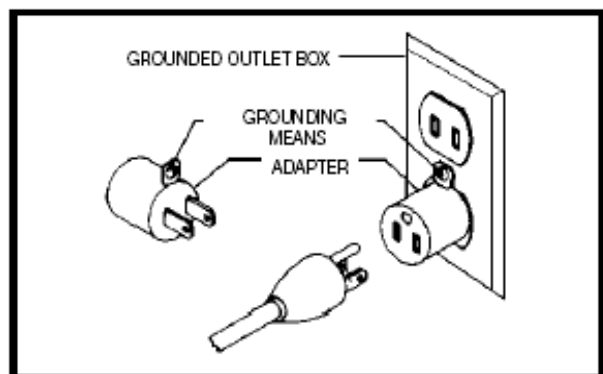
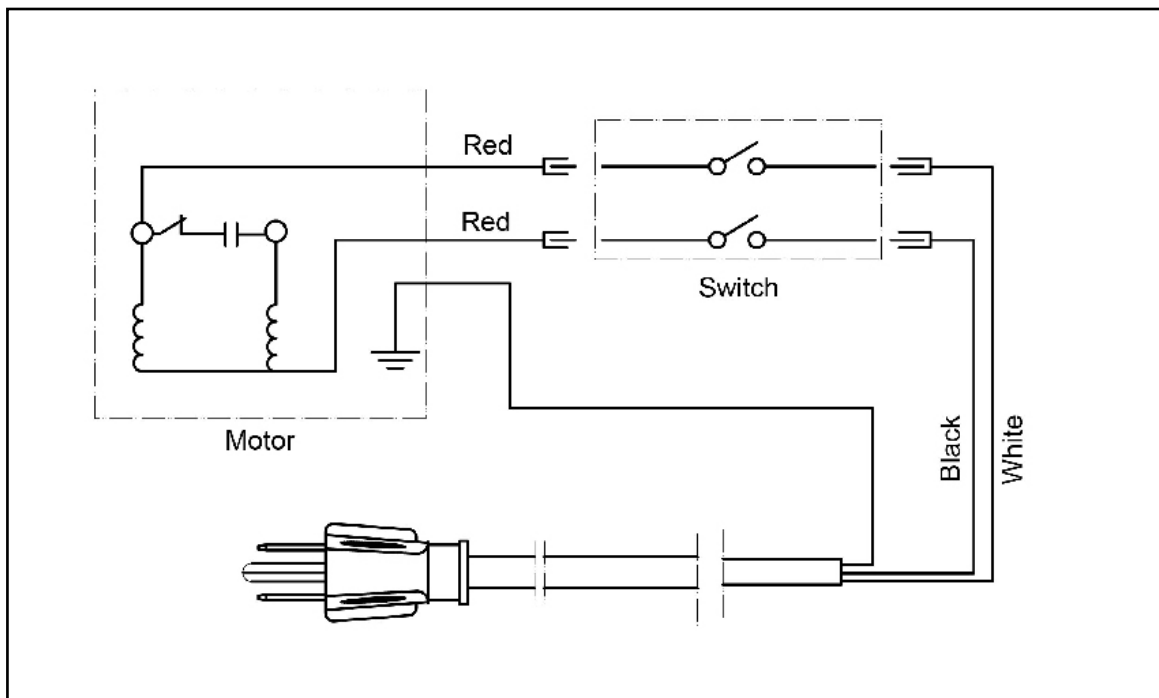

Fig. B

Troubleshooting

Symptom	Possible Cause	Solution
High collector pressure drop	<ol style="list-style-type: none"> 1. Malfunction of bag cleaning System 2. Ineffective cleaning 3. Re-entrainment of dust in collector due to low density 4. Wetting of bags 	<ol style="list-style-type: none"> 1. Check all cleaning system components 2. Clean bags or replace 3. Check discharge valves Lower A/C Ratio 4. Control dew point excursions Dry bags with clean air Clean bags or replace
Stack emission	<ol style="list-style-type: none"> 1. Bag permeability increase 2. Clean to dirty plenum leakage 3. Change of inlet conditions 	<ol style="list-style-type: none"> 1. Test bag or replace 2. Inspect and repair 3. Test & Review
Puffing back	<ol style="list-style-type: none"> 1. High pressure drop across the bag house 2. Plugged duct lines 3. Poor hood design 	<ol style="list-style-type: none"> 1. See above 2. Clean out 3. Evaluate temporary modifications and implement
Loud or unusual noises	<ol style="list-style-type: none"> 1. Vibrations 2. Banging of moving parts 	<ol style="list-style-type: none"> 1. Tighten all components or lay base stable 2. Tighten all parts or components

Wiring Diagram



Parts List

Part No.	Description	Part No.	Description
1	Base plate	21	Flat washer
2	Column	22	Hex socket head screw
3	Flat washer	23	Housing cover
4	Pan head screw	24	Upper bag support
5	Switch	25	Filter bag
6	Motor	26	Handle
7	Key	27	Hex bolt
8	Hex nut	28	Spacer
9	Rubber gasket	29	Vertical support
10	Dust bag	30	Hex bolt
12	Hex nut	31	Caster
13	Hex nut	32	Hex nut
14	Pan head screw	33	Bag strap
15	Flat washer	35	Collector housing
16	Motor cable	36	Pan head screw
17	Fan washer	37	Pan head screw
18	Filtration housing	38	Hex bolt
19	Spring washer		
20	Impeller		

Parts Explosion

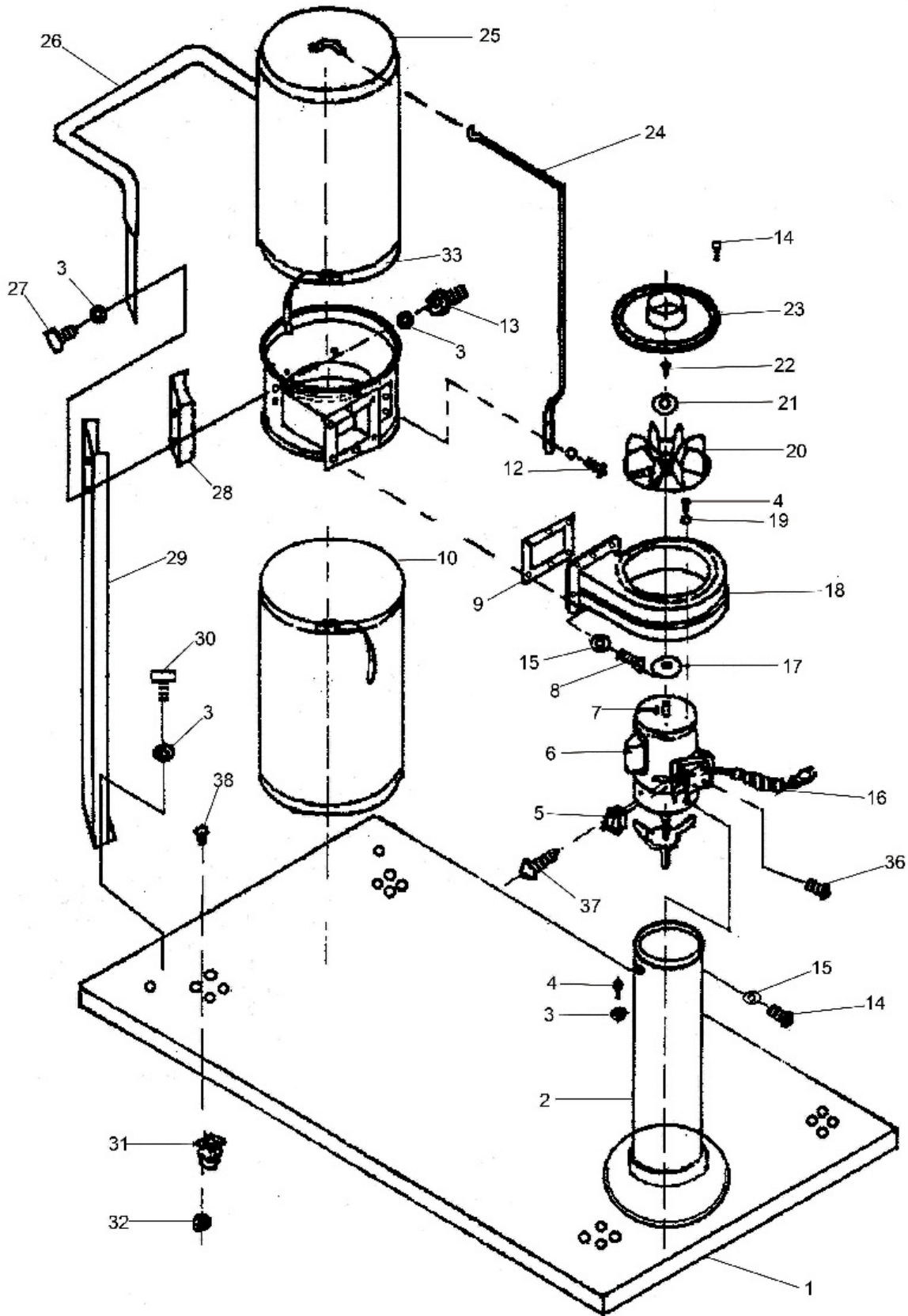

RIKON

POWER TOOLS

5-Year Limited Warranty

RIKON Power Tools Inc. ("Seller") warrants to only the original retail consumer/purchaser of our products that each product be free from defects in materials and workmanship for a period of five (5) years from the date the product was purchased at retail. This warranty may not be transferred.

This warranty does not apply to defects due directly or indirectly to misuse, abuse, negligence, accidents, repairs, alterations, lack of maintenance or normal wear and tear. Under no circumstances will Seller be liable for incidental or consequential damages resulting from defective products. All other warranties, expressed or implied, whether of merchantability, fitness for purpose, or otherwise are expressly disclaimed by Seller. This warranty does not cover products used for commercial, industrial or educational purposes.

This limited warranty does not apply to accessory items such as blades, drill bits, sanding discs, grinding wheels or belts and other related items.

Seller shall in no event be liable for death, injuries to persons or property, or for incidental, contingent, special, or consequential damages arising from the use of our products.

To take advantage of this warranty proof of purchase documentation, which includes date of purchase and an explanation of the complaint, must be provided.

The Seller reserves the right to effect at any time, without prior notice, those alterations to parts, fittings, and accessory equipment which they may deem necessary for any reason whatsoever.

To take advantage of this warranty, please fill out the enclosed warranty card and send it to:
RIKON Warranty
16 Progress Rd.
Billerica, MA 01821

The card must be entirely completed in order for it to be valid. If you have any questions please contact us at 877-884-5167 or warranty@rikontools.com.

Notes



**For more information:
16 Progress Rd
Billerica, MA 01821**

**877-884-5167 / 978-528-5380
techsupport@rikontools.com**